



The copyright of this drawing is vested with C+W O'Brien Ltd and must not be copied or reproduced without the consent of the company.

Figured dimensions only to be taken from this drawing. DO NOT SCALE. All contractors must visit the site and be responsible for checking all setting out dimensions and notifying the architect of any discrepancies prior to any manufacture or construction work.

NOTES:

Legend

- Studio
- 1 Bed - 2 Person
- 2 Bed - 3 Person
- 2 Bed - 4 Person
- 3 Bed - 5 Person
- Duplex - 2 Bed 4 Person
- Residential Amenity
- Creche Facility
- Office
- Commercial
- Retail
- Car parking
- Bike parking
- Plant room
- Refuse storage
- Bin Store
- Substation / Switch room
- Service
- Sprinklers tank
- Water storage room
- Heating Centre
- Circulation

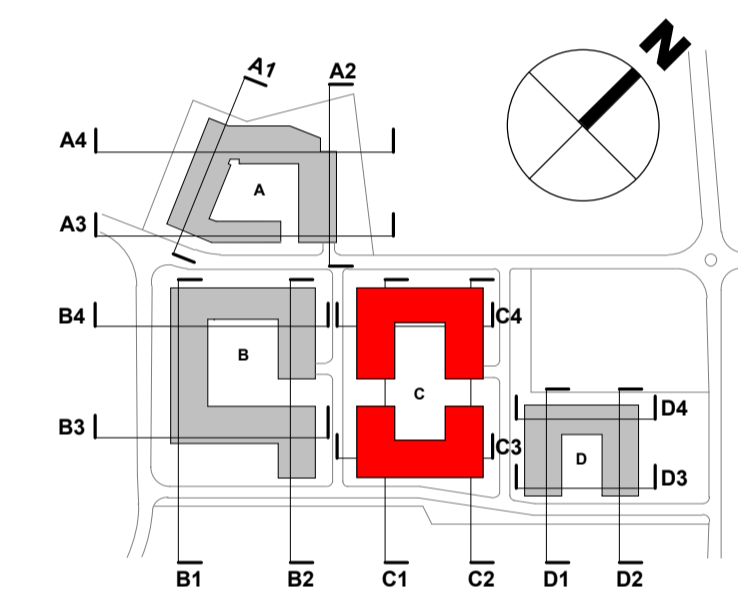

REV	DATE	SIGNED	NOTES

Project Stage

SHD Application

Client

Joseph Costello, Absolute Limousines Ltd and Boherhill Property Development Ltd.

Project

Lands west of Old Belgard Road and north, south and west of Cookstown Road, Cookstown Industrial Estate, Tallaght, Dublin 24

Drawing Title

PLAN - BLOCK C - LEVEL 03

Drawn	Checked	Scale @ A1	As	Date
AB	SOD	indicated	As	07/17/20

Project No.	Drawing No.
19127	1303

Drawing BIM Name:
P19127-CWO-03-03-DR-A-1303

CDE Area	Suitability Code	Revision
	S2	

C+W O'BRIEN ARCHITECTS

1 Sarsfield Quay, Arbour Hill, Dublin 7
t: 01 518 0170 e: admin@cwoarchitects.ie
Dublin | London | Warwick | Manchester
www.cwoarchitects.ie

Please consider the environment before printing this sheet